



**Flat , Grosvenor House, Grosvenor Park, Tunbridge Wells**  
**£1,200 pcm**

Newly refurbished two bedroom apartment **LET**



**PRESENCE & Co.**  
AGENTS • ESTATE AGENTS • PROPERTY MANAGERS • COMMERCIAL ESTATE AGENTS

Situated within walking distance of Tunbridge Wells town centre, is this elegant, comfortable two-bedroom apartment. The property comprises of two spacious bedrooms, a large open plan living area/ kitchen and shower room. The kitchen is fitted with appliances such as a dishwasher, fridge and washing machine.

Permit parking is available.

Deposit: £1,384.61

Holding Deposit: £276.92



Whilst every effort is made to ensure the accuracy of these details, it should be noted that the measurements are approximate only. Floorplans are for representation purposes only and prepared according to the RICS Code of Measuring Practice by our floorplan provider. Therefore, the layout of doors, windows and rooms are approximate and should be regarded as such by any prospective tenant.

# Grosvenor House, Grosvenor Park, Tunbridge Wells, TN1

Approximate Area = 576 sq ft / 53.5 sq m  
For identification only - Not to scale

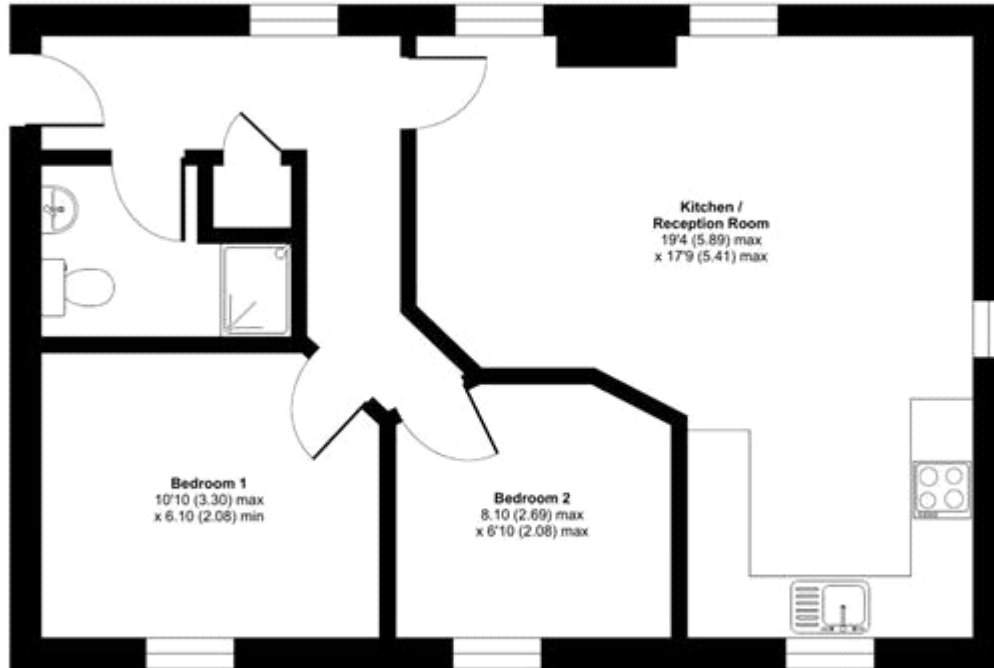

SECOND FLOOR



Floor plan produced in accordance with RICS Property Measurement Standards incorporating International Property Measurement Standards (IPMS2 Residential). © vichecom 2024. Produced for Presence & Co. REF: 1068955

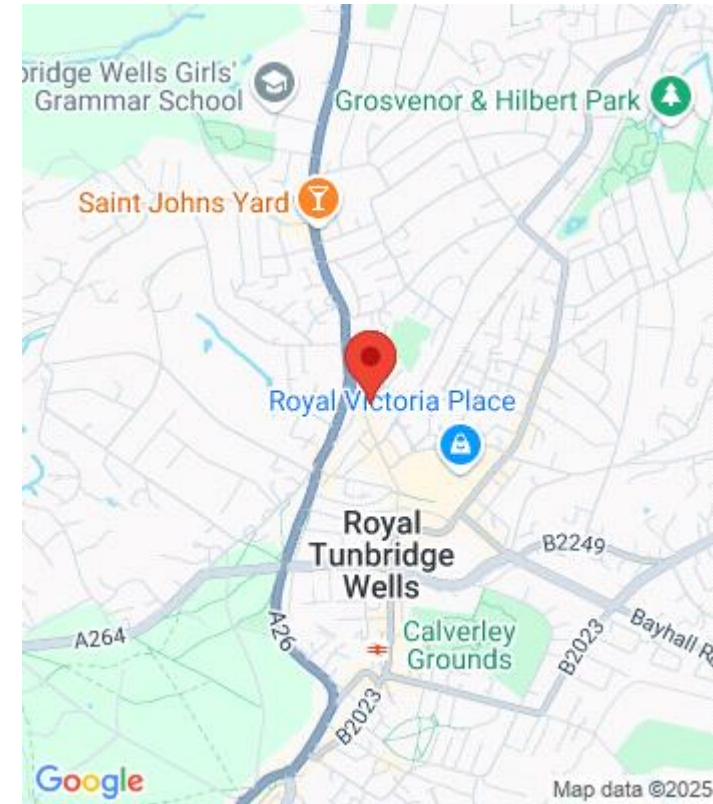

Energy Efficiency Rating		Current	Potential
Very energy efficient - lower running costs			
(92-100)	A		
(81-91)	B		
(69-80)	C	76	83
(55-68)	D		
(39-54)	E		
(21-38)	F		
(1-20)	G		
Not energy efficient - higher running costs			
England & Wales		EU Directive 2002/91/EC	

The energy efficiency rating is a measure of the overall efficiency of a home. The higher the rating the more energy efficient the home is and the lower the fuel bills will be.